

BUILDING 'B' ROOF PLAN
SCALE: 1/8" = 1'-0"

NOTE:
CONTRACTOR TO PROVIDE A \$15,000.00 ALLOWANCE IN HIS/HER BID FOR UNFORESEEN/MISCELLANEOUS CONDITIONS. WHEN FIGURING THIS ALLOWANCE IN THE BID, THE CONTRACTOR IS TO INCLUDE ALL NECESSARY OVERHEAD AND PROFIT TO CARRY THIS DOLLAR VOLUME. THIS ALLOWANCE IS NOT FOR THE CONTRACTOR'S BENEFIT, AND IS ONLY AUTHORIZED TO CHARGE AGAINST THIS ALLOWANCE WHEN DIRECTED AND APPROVED BY JOLIET JUNIOR COLLEGE. THE CONTRACTOR WILL BE ALLOWED TO INVOICE FOR DIRECT MATERIAL AND RAW LABOR COSTS ONLY.

NOTE:
SEE SPECIFICATION SECTION 012300 "ALTERNATES" FOR PROJECT REQUIREMENTS AFFECTING THE WORK.

ROOF AREAS SCOPE OF WORK

- ROOF AREAS 'A', 'B', 'C', 'E', 'F', AND 'G':**
 *EXISTING METAL ROOF DECK (SLOPED) TO REMAIN.
 *EXISTING 2 LAYERS OF 150" POLYISOCYANURATE BOARD INSULATION (MECHANICALLY ATTACHED) TO REMAIN.
 *REMOVE EXISTING FULLY ADHERED EPDM ROOFING SYSTEM.
 *CLEAN AND PREPARE EXISTING SURFACE.
 *NEW 230" POLYISOCYANURATE BOARD INSULATION IN URETHANE ADHESIVE.
 *NEW FULLY ADHERED EPDM ROOFING MEMBRANE AND FLASHINGS.
- ROOF AREA 'D':**
 *EXISTING METAL ROOF DECK (FLAT) TO REMAIN.
 *EXISTING 150" POLYISOCYANURATE BOARD INSULATION TO REMAIN.
 *EXISTING 150" (TAPERED) POLYISOCYANURATE BOARD INSULATION (MECHANICALLY ATTACHED) TO REMAIN.
 *REMOVE EXISTING FULLY ADHERED EPDM ROOFING SYSTEM.
 *CLEAN AND PREPARE EXISTING SURFACE.
 *NEW 230" POLYISOCYANURATE BOARD INSULATION IN URETHANE ADHESIVE.
 *NEW FULLY ADHERED EPDM ROOFING MEMBRANE AND FLASHINGS.

ROOF PLAN GENERAL NOTES

- ALL MATERIALS REMOVED AND NOT SALVAGED OR REUSED SHALL BE PROPERLY DISPOSED OF OFF SITE BY CONTRACTOR.
- VERIFY ANY ADDITIONAL DEMOLITION WORK REQUIRED FOR THE REMOVAL/REPLACEMENT OF EXISTING ROOF.
- ROOFING MEMBRANE AND/OR SYSTEM SHALL BE A COMPLETE SYSTEM PER MANUFACTURER'S RECOMMENDATIONS AND REQUIRED WARRANTY.
- COORDINATE ALL OTHER ROOF PENETRATIONS/TERMINATIONS IN FIELD WITH MANUFACTURER'S APPROVED FLASHING DETAILS (V.I.F.).

ROOF PLAN LEGEND

- EXISTING HVAC EQUIPMENT ON ROOF CURB. VERIFY EXACT SIZES AND LOCATIONS IN FIELD. EXISTING EQUIPMENT TO REMAIN. EXISTING BASE FLASHING TO BE REMOVED. NEW EPDM BASE FLASHING WITH NEW SLIP METAL COUNTERFLASHING AND CAULK. PER ROOFING MEMBRANE MANUFACTURER'S REQUIREMENTS.
- EXISTING EXHAUST FAN/HOOD ON ROOF CURB. VERIFY EXACT SIZES AND LOCATIONS IN FIELD. EXISTING FAN/HOOD TO BE REMOVED. EXISTING BASE FLASHING TO BE REMOVED. NEW EPDM BASE FLASHING. FULL HEIGHT. RESET FAN/HOOD WITH NEW GASKETED FASTENERS IN ALL MOUNTING HOLES. PER ROOFING MEMBRANE MANUFACTURER'S REQUIREMENTS.
- EXISTING PIPE PORTAL PENETRATION THROUGH ROOF. VERIFY EXACT SIZES AND LOCATIONS IN FIELD. EXISTING FLASHING AND PORTAL TO BE REMOVED. RESET EXISTING PORTAL ON TOP OF NEW INSULATION. NEW EPDM BASE FLASHING. PER ROOFING MEMBRANE MANUFACTURER'S REQUIREMENTS.
- EXISTING PLUMBING VENT PENETRATION THROUGH ROOF. VERIFY EXACT QUANTITIES AND SIZES AND LOCATIONS IN FIELD. EXISTING FLASHING TO BE REMOVED. VERIFY HEIGHT OF VENT PIPE TO BE 8" MIN TO 12" MAX ABOVE NEW ROOF SURFACE. ADD COUPLING SLEEVE AND EXTENSION IF NEEDED. NEW EPDM FLASHING BOOT PER ROOFING MEMBRANE MANUFACTURER'S REQUIREMENTS.
- EXISTING FLUE STACK PENETRATION THROUGH ROOF. VERIFY EXACT SIZES AND LOCATIONS IN FIELD. EXISTING BASE FLASHING TO BE REMOVED. EXISTING METAL COUNTERFLASHING TO REMAIN. NEW EPDM FLASHING BOOT PER ROOFING MEMBRANE MANUFACTURER'S REQUIREMENTS.
- EXISTING ROOF DRAIN LOCATION TO REMAIN. VERIFY EXACT SIZES AND LOCATIONS IN FIELD. SALVAGE EXISTING BASKET AND CLAMPING RING. CLEAN AND REINSTALL WITH FASTENERS EXISTING OR NEW. VERIFY CLAMPING RING HOLES. PER ROOFING MEMBRANE MANUFACTURER'S REQUIREMENTS.
- EXISTING/NEW SUMP AT ROOF DRAIN LOCATION. VERIFY EXACT SIZES AND LOCATIONS IN FIELD. TRIM EDGES OF EXISTING INSULATION BOARDS (TWO STEPS) TO BE ONE VERTICAL IN TWO HORIZONTAL. NEW INSULATION OVERLAY (STEP THREE) TO HAVE SAME BEVEL. PER ROOFING MEMBRANE MANUFACTURER'S REQUIREMENTS.
- EXISTING THROUGH-WALL SCUPPER. VERIFY EXACT SIZES AND LOCATIONS IN FIELD. EXISTING METAL SCUPPER SLEEVE TO REMAIN. EXISTING ROOF FLASHINGS TO BE REMOVED. NEW EPDM FLASHING PER ROOFING MEMBRANE MANUFACTURER'S REQUIREMENTS. IF NEW INSULATION OVERLAY IS HIGHER THAN SCUPPER BACK BEVEL INSULATION ON TWO HORIZONTAL IN TWO HORIZONTAL TO MEET SCUPPER HEIGHT. EXISTING CAULK AROUND EXTERIOR OF METAL SCUPPER TO BE REMOVED AND REPLACED. COLOR TO MATCH EXISTING WHITE.

ROOF PLAN KEY NOTES

- EXISTING ROOF, COPING, ETC. TO REMAIN UNLESS NOTED OTHERWISE. PROVIDE PROTECTION AS NEEDED DURING CONSTRUCTION OPERATIONS.
- EXISTING TAPERED INSULATION SADDLES AND CRICKETS TO REMAIN, UNLESS NOTED OTHERWISE (TYPICAL).
- EXISTING SURFACE MOUNTED LIGHT FIXTURE, POLE MOUNT, AND LOOSE ELECTRICAL CORDS TO BE REMOVED. VERIFY WITH OWNER AND SALVAGE AS REQUESTED.
- NEW 1/4" PER 12" TAPERED INSULATION TO ASSIST ROOF DRAINAGE. APPROXIMATE AREA(S) AS INDICATED. VERIFY IN FIELD. SET IN URETHANE ADHESIVE PRIOR TO NEW INSULATION OVERLAY.
- 30" SQUARE WHITE EPDM WALKWAY PADS ADHERED TO NEW ROOFING MEMBRANE. VERIFY EXACT LAYOUT ALL AROUND EXISTING AIR HANDLER EQUIPMENT, V.I.F.
- 30" SQUARE WHITE EPDM WALKWAY PADS ADHERED TO NEW ROOFING MEMBRANE AT BASE OF ALL ROOF LADDERS, V.I.F.
- FOUR 30" SQUARE WHITE EPDM WALKWAY PADS ADHERED TO NEW ROOFING MEMBRANE AT LOCATION OF ROOF ACCESS DOOR IN SIDEWALL, V.I.F.
- LOCATION OF GRADE ACCESS TO ROOF SURFACE FOR USE BY CONTRACTOR. VERIFY EXACT LOCATION(S) WITH OWNER.

ROOF PERIMETER KEY NOTES

- EXISTING METAL COPING CAPS TO BE REMOVED AND SALVAGED. AFTER NEW ROOFING, REINSTALL COPING CAPS WITH NEW GASKETED FASTENERS, ALL JOINTS TO BE SEALED.
- EXISTING METAL COUNTERFLASHING TO BE REMOVED AND SALVAGED. EXISTING FLASHING RECEIVER TO REMAIN. AFTER NEW ROOFING, REINSTALL COUNTERFLASHING. CAULK JOINT ABOVE FLASHING RECEIVER TO EIFS WALL. IS TO BE REMOVED AND REPLACED WITH NEW BACKER ROD AND SEALANT. COLOR TO MATCH EXISTING WHITE.
- EXISTING METAL COUNTERFLASHING TO BE REMOVED AND SALVAGED. EXISTING FLASHING RECEIVER TO REMAIN. AFTER NEW ROOFING, REINSTALL COUNTERFLASHING.
- NEW METAL BASE FLASHING (COLOR TO MATCH COPING CAPS) AT COPING END TO EIFS WALL. CAULK TO WALL.
- EXISTING METAL COUNTERFLASHING TO BE REMOVED AND DISCARDED. EXISTING FLASHING RECEIVER TO REMAIN. AFTER NEW ROOFING, PROVIDE NEW METAL COUNTERFLASHING (COLOR MATCH TO WINDOWS) OF SHORTER HEIGHT DUE TO INCREASED ROOF THICKNESS, V.I.F.
- NEW TERMINATION BAR WITH SEALANT AT 12" ABOVE ROOF SURFACE. MATCH EXISTING HEIGHT, V.I.F.
- FULL HEIGHT BASE FLASHING. NEW TERMINATION BAR WITH SEALANT AT EXISTING UPPER COPING CAP TO REMAIN ABOVE ROOF SURFACE, V.I.F.
- EXISTING METAL COUNTERFLASHING TO BE REMOVED AND DISCARDED AT BASE OF LOUVER. EXISTING FLASHING RECEIVER TO REMAIN. AFTER NEW ROOFING, PROVIDE NEW METAL COUNTERFLASHING (COLOR TO MATCH EXISTING WHITE) OF SHORTER HEIGHT DUE TO INCREASED ROOF THICKNESS, V.I.F.

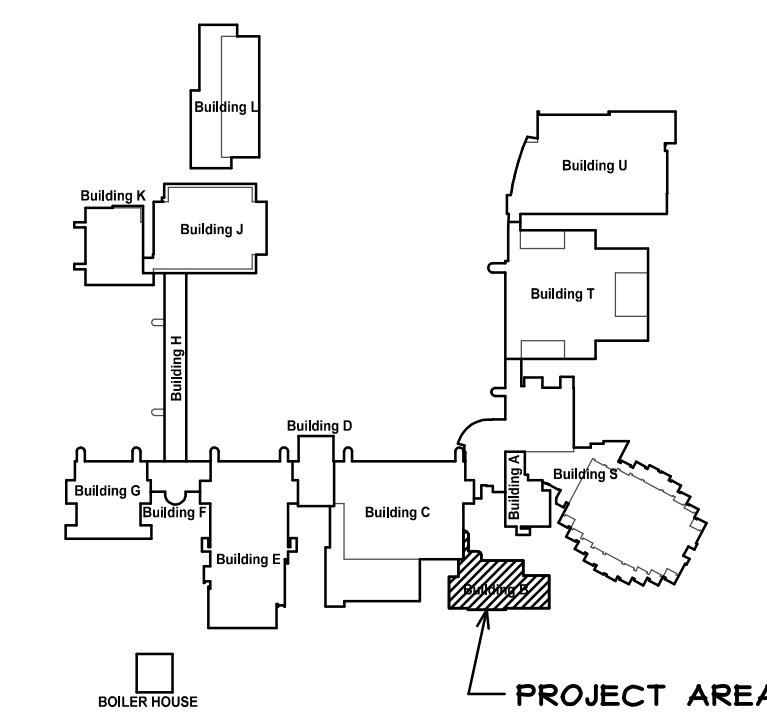

CAMPUS KEY PLAN
NO SCALE

REGISTRATION

stromsland + de young + pybyls
ARCHITECTURE GROUP
20200 Burl Court - 102
Joliet, Illinois 60433
www.sdpagroup.com
815-727-1311
L. N.: 184-000437

NUMBER

SET

ROOF REPLACEMENT - BUILDING B
JOLIET JUNIOR COLLEGE
BUILDING B
1215 HOUBOLT ROAD
JOLIET, ILLINOIS

DATE: 10/28/2018
REVISED:
PROJECT NO.
1808-08
SHEET NUMBER
A1
OF 1 SHEETS

COPYRIGHT 2018 © S D P ARCHITECTURE GROUP, INC.