

Addendum No. 1

Page 1 of 1

DATE: November 18, 2011

Joliet Junior College
1215 Houbolt Road
Joliet, IL 60431

TO: Prospective Bidders

SUBJECT: Addendum No. 1

PROJECT NAME: Environmental Remediation of E Building

JJC PROJECT NO.: B11052

This Addendum forms a part of the Bidding and Contract Documents and modifies the original bidding document as posted on the JJC website. Acknowledge receipt of this addendum in the space provided on the Bid Form. FAILURE TO DO SO MAY SUBJECT BIDDER TO DISQUALIFICATION.

The contractor is to include a \$10,000 allowance in their base bid to cover any additional work directed by JJC outside of the base scope of work. The contractor is to include any necessary overhead and profit needed for this allowance in their base bid. Should JJC direct any work against this allowance, the contractor shall invoice for direct material and raw labor costs only.

Demolition drawings (AD101 and AD102) prepared by Legat Architects has been included as part of this addendum. These demo drawings are for reference only to show locations of table tops, sinks, etc. as the actual demo work is being performed by others.

The scope of work that states to remove traps, shall be considered revised to mean that all waste piping, traps, separator chambers, etc. from sinks to floor level/wall connection/base of wall cabinet shall be removed and disposed of by this contractor. All work related to removing/disposing of this material shall be in compliance with OSHA training for mercury work. There are a total of 36 sinks on the first floor and 33 sinks on the second floor that require removal of waste piping/material (reference items marked E2 & E10 on the demo drawings).

As stated in the prebid meeting, an elevator will not be accessible for this project. The southwest stairs should be used for all activity related to this project.

Refer to the attached Revised Scope of Work Statement for revised lab top and fume hood tables.

End of Addendum #1

Revised Scope of Work Statement

Asbestos Abatement of
 "E" Building
 2011 Renovations
 Joliet Junior College
 TEM Project 44064
 November 14, 2011

Table 1
 Summary of Scope of Work
 Asbestos Containing Lab Table Tops and Fume Hoods

Room No.	Lab Table Tops (# and dimensions in feet)	Description	Fume Hoods (each)
1003	1x2x24	Wall bench	1
	3x5x12	With end sink, gas, water and electric	
	1x5x12	Demo station	
	1x4.5x12	Work table	
1004	1x2x18	Wall bench	1
	1x5x16	Demo station	
	3x3.5x12.5	With center sink, gas, water and electric	
	1x3x8	Work table	
	1x2x20	Wall table	
1005	1x2x16	Wall bench	1
	3x3.5x12.5	With center sink, gas, water and electric	
	1x3x8	Demo station	
1006	2x4x11.5	With end sink, gas, water and electric. 2 of same to remain.	
1036	1x2x39	Wall bench	0
1010	3x3.5x12.5	With center sink, gas, water and electric	1
	1x2x16	Wall bench	
	1x3x8	Demo station	
1008	1x3x8	Wall bench	0
	1x2x8	Wall bench	
	3x4x12.5	With center sink, gas, water and electric	
1009	1x2.5x18	Wall bench	1
	1x4.5x16	Demo station	
	4x4x12	With center sink, gas, water and electric	
	2x2x6	Work tables	
	2x2x8	Work tables	
1038	1x3x4	Work table	0
1037	1x3x4	Work table	0

Revised Scope of Work Statement

Asbestos Abatement of
 "E" Building
 2011 Renovations
 Joliet Junior College
 TEM Project 44064
 November 14, 2011

Room No.	Lab Table Tops (# and dimensions in feet)	Description	Fume Hoods (each)
2012	7x5x6	Work tables	0
	1x3x12.5	Demo station	
	3x2x14	Wall table	
2013A	1x2x4	Sink cabinet	0
	1x2x20	Wall table	
2014	1x3x8	Wall bench	0
2017	0		0
2018	1x3x8	Wall bench	0
2019	1x3x8	Instrument bench	
	1x3x3	Instrument bench	
	1x2x24	Instrument table	
	1x2x24	Instrument bench	
	2x4x6	Instrument bench	
	1x2x17	Instrument bench	
1x3x3	Instrument bench		
2011	4x6x12	With center trough, shelve, gas, water, electric and two sinks	2
	1x2x16.5	Wall bench	
	2x2x8	Wall bench	
	1x2x20	Wall bench	
2010	4x4.5x12	With center trough, shelve, gas, water, electric and two sinks	2
	1x2x16.5	Wall bench	
	1x2x8	Wall bench	
	1x2x20	Wall bench	
	1x2x8	Wall bench	
2006	0	New fixtures	0
2007	3x4.5x12	With center trough, shelve, gas, water, electric and two sinks	0
2008	8x6x6	Tables	
2009	1x4x8	Demo station	0
	1x2x20.8	Wall bench	

Revised Scope of Work Statement

Asbestos Abatement of
"E" Building
2011 Renovations
Joliet Junior College
TEM Project 44064
November 14, 2011



Lab table with "center sink, gas, water and electric",
typical for biology labs



"Demo Station", typical throughout labs

Revised Scope of Work Statement

Asbestos Abatement of
"E" Building
2011 Renovations
Joliet Junior College
TEM Project 44064
November 14, 2011



"Wall table" with back splash



Lab benches with center trough, shelf, gas, water, electric
and two sinks, Typical in chemistry labs

Revised Scope of Work Statement

Asbestos Abatement of
"E" Building
2011 Renovations
Joliet Junior College
TEM Project 44064
November 14, 2011



Work tables, typical throughout labs

Revised Scope of Work Statement

Asbestos Abatement of
"E" Building
2011 Renovations
Joliet Junior College
TEM Project 44064
November 14, 2011



Sink trap with separator chamber. Remove piping to wall.



Sink trap with no "p trap". Remove piping down to floor of cabinet

Joliet Junior College

Natural Sciences Addition & Renovation

1215 Houboff Road
Joliet, IL 60431

ARCHITECT
Legat Architects
651 W. Washington Blvd, Suite 1
Chicago, IL 60661

CIVIL ENGINEER
Ruettiger, Tonelli & Associates, Inc.
2174 Oneida Street
Joliet, IL 60435

STRUCTURAL, MECHANICAL,
ELECTRICAL, PLUMBING, FIRE
PROTECTION, and TECHNOLOGY
ENGINEER

KJWW Engineering
1100 Warrenville Rd., Suite 400W
Naperville, IL 60563

SCIENCE LAB CONSULTANT
Harley Ellis Devereaux
401 W. Superior
Chicago, IL 60654

CONSTRUCTION MANAGER
Gilbane Building Company
8550 West Bryn Mawr Avenue, Suite 500
Chicago, IL 60631

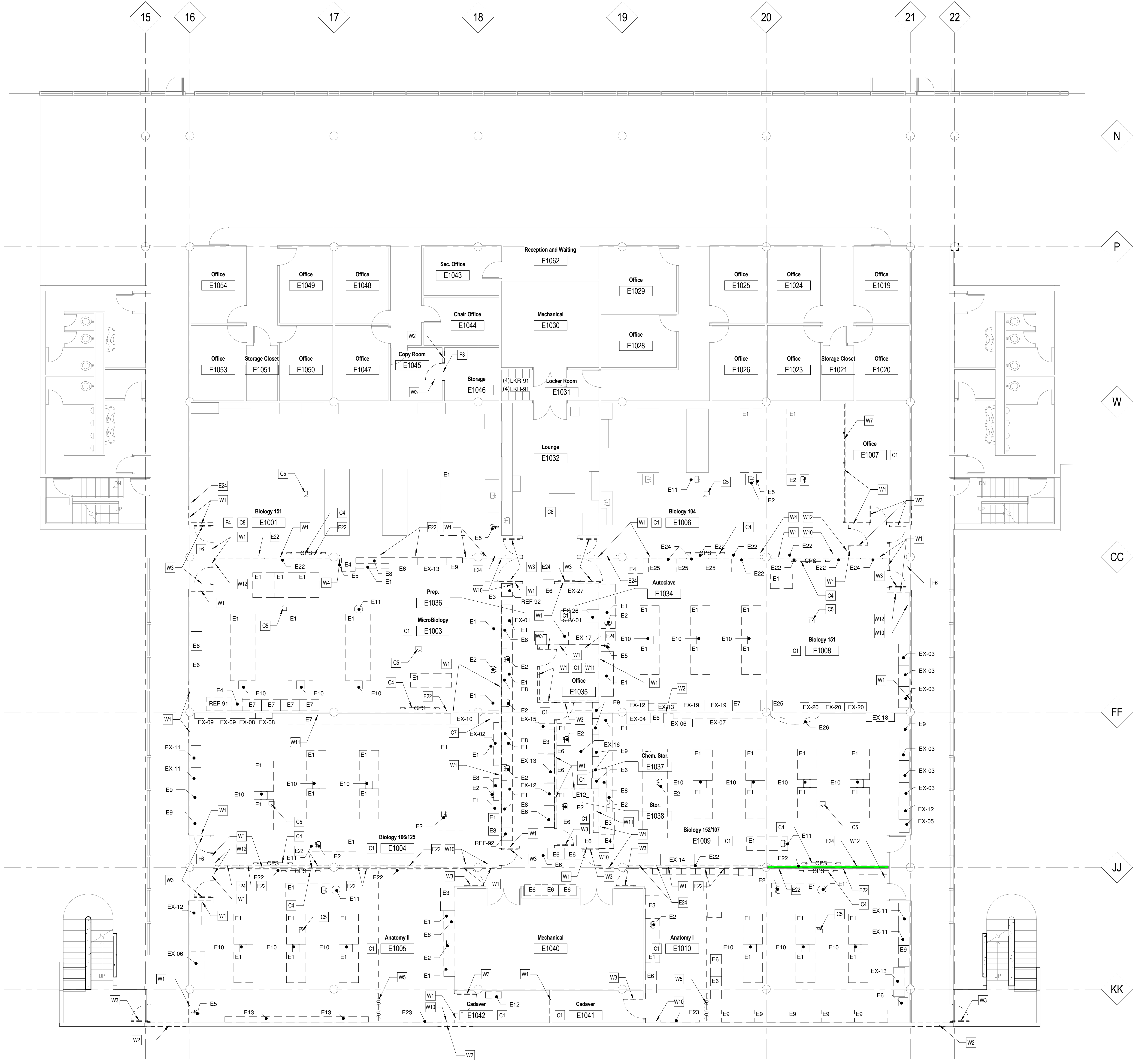

Demolition Work Notes

- E1, E2, E3, etc Existing equipment items to be removed.
E.T.R. Existing equipment to remain.
- All other items are existing equipment to be removed and relocated. See equipment schedule on sheet AQ-602 and AQ-603 for corresponding tag number and new location.
- Remove steel access floor plates at all trench ducts. Refer to Plumbing.
- Remove all existing interior room signage from Building E in its entirety and patch and refresh drywall as necessary at the location of the removed signs.
- Remove and relocate fire extinguishers and fire blankets as needed throughout renovated rooms only.
- Remove first aid kits, soap dispensers, and paper towel holders as needed throughout renovated rooms only.
- F1. Remove VCT flooring.
F2. Remove carpet.
F3. Following the demolition and the installation of the future opening, patch floor as necessary.
F4. Remove sheet vinyl flooring and patch as necessary after the installation of future walls.
F5. Remove metal cover plates at floor troughs. Refer to Structural for exact locations.
F6. Remove VCT flooring as necessary to accommodate future work.
- W1. Remove gypsum board and framing of wall full height to the extents shown.
W2. Remove gypsum board and framing of wall as necessary for installation of future door and/or opening.
W3. Remove door, frame, and hardware.
W4. Remove flag and bracket (salvage to owner).
W5. Remove curtain partition and track.
W6. Remove roller maps and brackets (salvage to owner).
W7. Remove window frame and glazing.
W8. Remove roller map storage and framing.
W9. Remove wall-hung projector screen and bracket (salvage to owner).
W10. Remove coat racks (salvage to owner).
W11. Remove wall-mounted shelving and support brackets.
W12. Remove pencil sharpeners (salvage to owner).
- C1. Remove ceiling in its entirety.
C2. Remove and relocate ceiling-hung projection screen, brackets, and projector. Refer to Technology.
C3. Remove projection screen and anchoring board (salvage to owner).
C4. Remove projection screen and brackets (salvage to owner).
C5. Remove and relocate ceiling-mounted projector and supports. Refer to Technology.
C6. Remove ACT ceiling in its entirety. Reinstall existing lights into new 2' x 2' ACT ceiling. Refer to Architectural.
C7. Remove wood framing and hooks.
C8. Remove ACT ceiling grid and tile as necessary to allow for installation of future walls.
C9. Remove and properly reinstall the ceiling-mounted projection screen and brackets in the same location.
- E1. Remove existing wood lab casework, deck-mounted shelving, gas piping, deck-mounted apparatuses, plumbing piping, faucets, and valves, where present. Existing resin top removed by others (not in contract).
E2. Remove existing wood sink bases, sink, and plumbing. Existing resin top removed by others (not in contract).
E3. Remove existing fume hood.
E4. Remove existing refrigerator.
E5. Remove existing emergency shower, curtain, and track.
E6. Remove existing metal or wood cabinets. Remove existing wood-framed table and table-mounted apparatuses. Existing resin top removed by others (not in contract).
E8. Remove existing wall-mounted cabinets.
E9. Remove existing wood shelving.
E10. Remove existing floor-mounted utility sink, faucet, and plumbing.
E11. Remove existing eye wash.
E12. Remove existing floor-mounted shelving.
E13. Remove existing floor-mounted glass front cabinets.
E14. Remove existing metal lockers.
E15. Remove existing movable laptop cabinets.
E16. Not Used.
E17. Remove existing drain trough and associated plumbing at lab bench.
E18. Remove existing ceiling-mounted projector and supports.
E19. Remove existing spectrometer.
E20. Remove existing ice machine and plumbing.
E21. Remove existing gas cylinder restraint.
E22. Remove existing wall-mounted white board.
E23. Remove existing ventilating equipment.
E24. Remove existing wall-mounted bulletin board or chalk board.
E25. Remove existing metal-framed table.
E26. Remove existing stone built-in.

Demolition Legend

- GPS— Ceiling-mounted Projection Screen
- WPS— Wall-mounted Projection Screen
- Roller Map
- Projector
- Items to remain
- Items to be removed

1 First Floor Demolition Plan
1/8" = 1'-0"

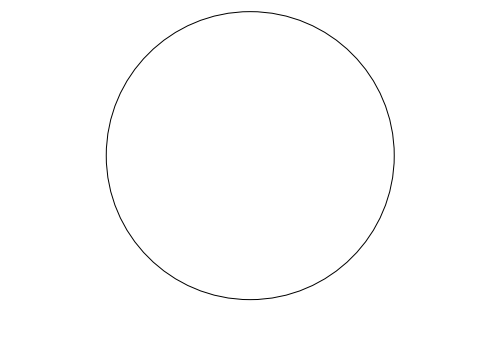

SIGNATURE _____
DATE _____

REVISIONS

NO.	DESCRIPTION	DATE

PROJECT NUMBER 209087.00
DATE 11-8-2010
DRAWN BY ERC
CHECKED BY Checker

First Floor Demolition Plan

AD-101

Issued for Construction

Joliet Junior College

Natural Sciences Addition & Renovation

1215 Houbolt Road
Joliet, IL 60431

ARCHITECT
Legat Architects
651 W. Washington Blvd, Suite 1
Chicago, IL 60661

CIVIL ENGINEER
Ruetiger, Tonelli & Associates, Inc.
2174 Oneida Street
Joliet, IL 60435

STRUCTURAL, MECHANICAL,
ELECTRICAL, PLUMBING, FIRE
PROTECTION, and TECHNOLOGY
ENGINEER

KJWW Engineering
1100 Warrenville Rd., Suite 400W
Naperville, IL 60563

SCIENCE LAB CONSULTANT
Harley Ellis Devereaux
401 W. Superior
Chicago, IL 60654

CONSTRUCTION MANAGER
Gilbane Building Company
8550 West Bryn Mawr Avenue, Suite 500
Chicago, IL 60631

Demolition Work Notes

- E1, E2, E3, etc. Existing equipment items to be removed.
- E.T.R. Existing equipment to remain.
- All other items are existing equipment to be removed and relocated. See equipment schedule on sheet AQ-602 and AQ-603 for corresponding tag number and new location.
- Remove steel access floor plates at all trench ducts. Refer to Plumbing.
- Remove all existing interior room signage from Building E in its entirety and patch and refinish drywall as necessary at the location of the removed signs.
- Remove and relocate fire extinguishers and fire blankets as needed throughout renovated rooms only.
- Remove first aid kits, soap dispensers, and paper towel holders as needed throughout renovated rooms only.
- Remove VCT flooring as necessary to accommodate future work.
- F1. Remove VCT flooring.
- F2. Remove carpet.
- F3. Following the demolition and the installation of the future opening, patch floor as necessary.
- F4. Remove sheet vinyl flooring and patch as necessary after the installation of future walls.
- F5. Remove metal cover plates at floor troughs. Refer to Structural for exact locations.
- F6. Remove VCT flooring as necessary to accommodate future work.
- W1. Remove gypsum board and framing of wall full height to the extents shown.
- W2. Remove gypsum board and framing of wall as necessary for installation of future door and/or opening.
- W3. Remove door, frame, and hardware.
- W4. Remove flag and bracket (salvage to owner).
- W5. Remove curtain partition and track.
- W6. Remove roller maps and brackets (salvage to owner).
- W7. Remove window frame and glazing.
- W8. Remove roller map storage and framing.
- W9. Remove wall-hung projector screen and bracket (salvage to owner).
- W10. Remove coat racks (salvage to owner).
- W11. Remove wall-mounted shelving and support brackets.
- W12. Remove pencil sharpeners (salvage to owner).
- C1. Remove ceiling in its entirety. Remove and relocate ceiling-hung projection screen, brackets, and projector. Refer to Technology.
- C3. Remove projection screen and anchoring board (salvage to owner).
- C4. Remove projection screen and brackets (salvage to owner).
- C5. Remove and relocate ceiling-mounted projector and supports. Refer to Technology.
- C6. Remove ACT ceiling in its entirety. Reinstall existing lights into new 2' x 2' ACT ceiling. Refer to Architectural.
- C7. Remove wood framing and hooks.
- C8. Remove ACT ceiling grid and tie as necessary to allow for installation of future walls.
- C9. Remove and properly reinstall the ceiling-mounted projection screen and brackets in the same location.
- E1. Remove existing wood lab casework. Remove electrical and data connections, deck-mounted shelving, gas piping, deck-mounted apparatuses, plumbing piping, faucets, and valves, where present. Existing resin top removed by others (not in contract).
- E2. Remove existing wood sink base, sink, and plumbing. Existing resin top removed by others (not in contract).
- E3. Remove existing fume hood.
- E4. Remove existing refrigerator.
- E5. Remove existing emergency shower, curtain, and track.
- E6. Remove existing metal or wood cabinets.
- E7. Remove existing wood framed table and table-mounted apparatuses. Existing resin top removed by others (not in contract).
- E8. Remove existing wall-mounted cabinets.
- E9. Remove existing wood shelving.
- E10. Remove existing floor-mounted utility sink, faucet, and plumbing.
- E11. Remove existing eye wash.
- E12. Remove existing floor-mounted shelving.
- E13. Remove existing floor-mounted glass from cabinets.
- E14. Remove existing metal lockers.
- E15. Remove existing movable laptop cabinets.
- E16. Not Used
- E17. Remove existing drain trough and associated plumbing at lab bench.
- E18. Remove existing ceiling-mounted projector and supports.
- E19. Remove existing spectrometer.
- E20. Remove existing ice machine and plumbing.
- E21. Remove existing gas cylinder restraint.
- E22. Remove existing wall-mounted white board.
- E23. Remove existing ventilating equipment.
- E24. Remove existing wall-mounted bulletin board or chalk board.
- E25. Remove existing metal-framed table.
- E26. Remove existing stone built-in.

Demolition Legend

- Ceiling-mounted Projection Screen
- Wall-mounted Projection Screen
- Roller Map
- Projector
- Items to remain
- Items to be removed

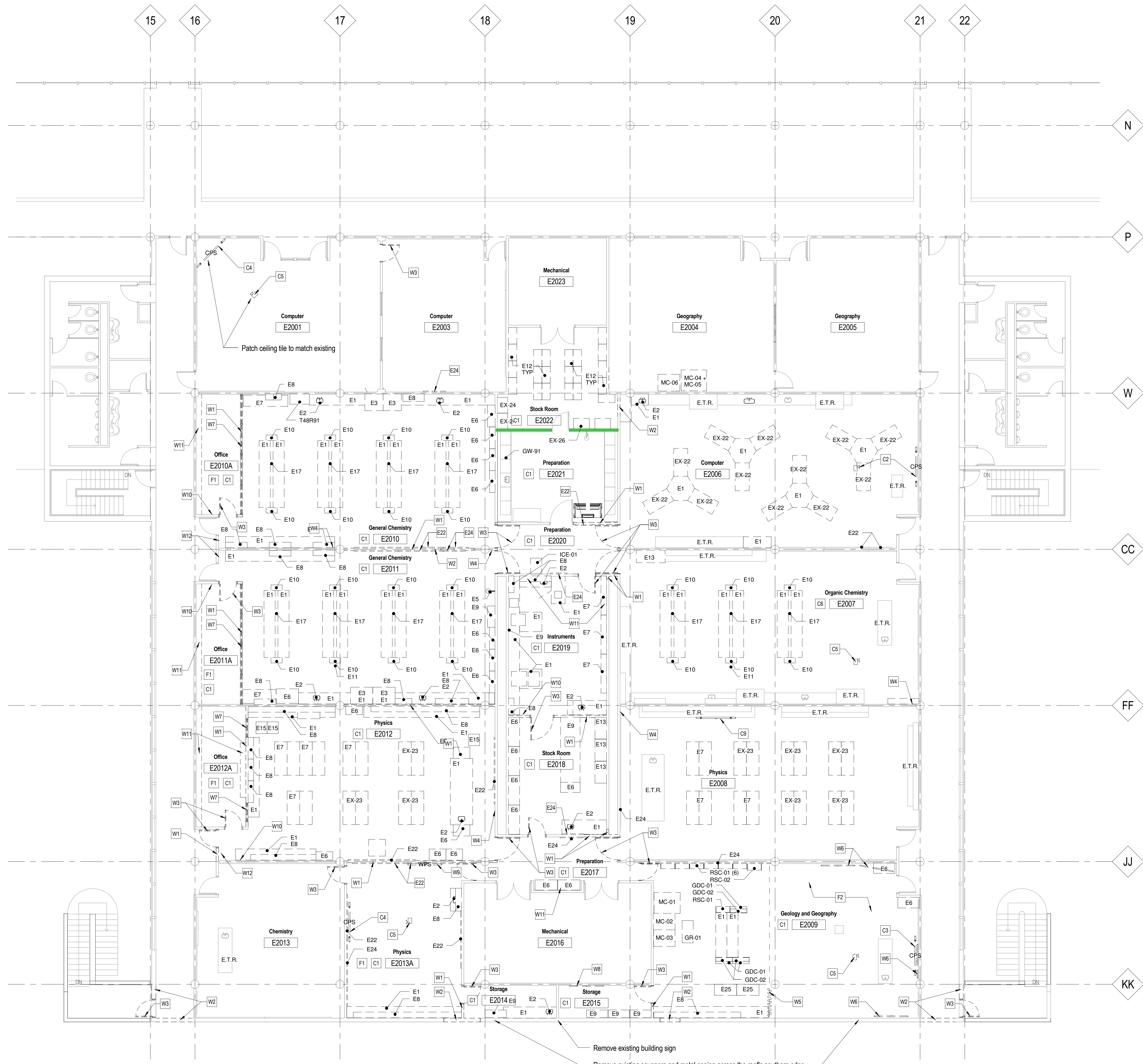

1 Second Floor Demolition Plan
1/8" = 1'-0"

SIGNATURE _____
DATE _____

REVISIONS

NO.	DESCRIPTION	DATE

PROJECT NUMBER 209087.00
DATE 11-8-2010
DRAWN BY ERC
CHECKED BY Checker

Second Floor Demolition Plan

AD-102

Issued for Construction